

平面图

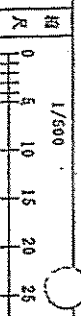

中山五月台  
小学校

教室使用状況調査

220

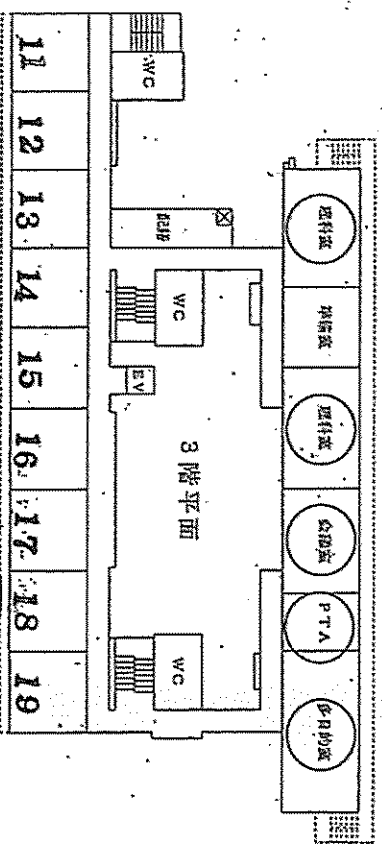
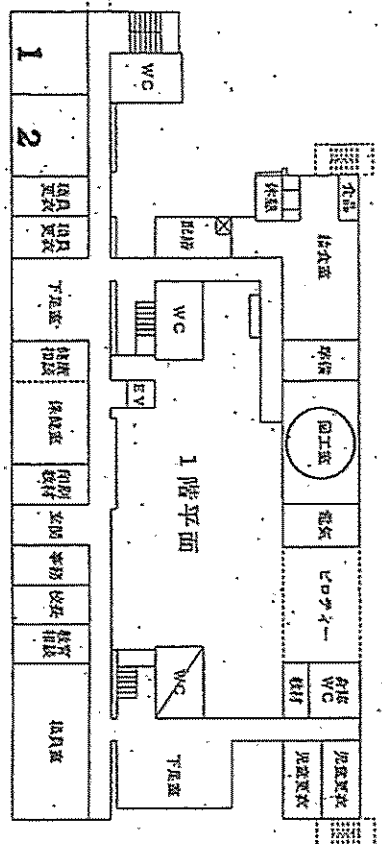
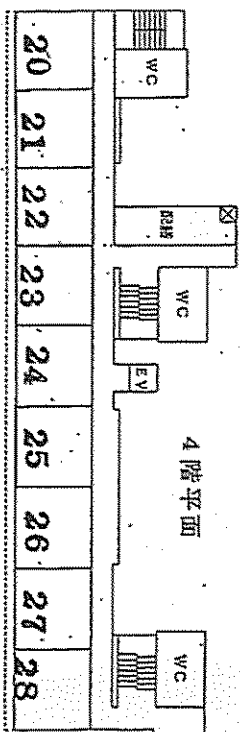
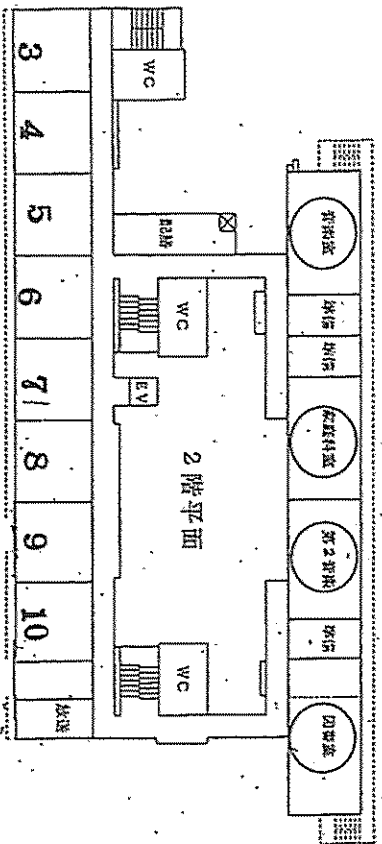

(平成 29 年度)

配 置 図

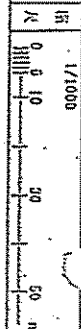

中山五月台  
小学校

児童数	218
児童数	214
児童数	055
児童数	050

1006

凡 例

建物

- ① 校舎 (School Building)
- ② 体育館 (Gymnasium)
- ③ 児童館 (Children's Center)
- ④ 調理室 (Kitchen)
- ⑤ 事務室 (Office)
- ⑥ 図書室 (Library)
- ⑦ 音楽室 (Music Room)
- ⑧ 美術室 (Art Room)
- ⑨ 保健室 (Nurse's Office)
- ⑩ 校長室 (Principal's Office)
- ⑪ 職員室 (Staff Room)
- ⑫ 会議室 (Meeting Room)
- ⑬ 待合室 (Waiting Room)
- ⑭ トイレ (Toilet)
- ⑮ 倉庫 (Warehouse)
- ⑯ 倉庫 (Warehouse)
- ⑰ 倉庫 (Warehouse)
- ⑱ 倉庫 (Warehouse)
- ⑲ 倉庫 (Warehouse)
- ⑳ 倉庫 (Warehouse)
- ㉑ 倉庫 (Warehouse)
- ㉒ 倉庫 (Warehouse)
- ㉓ 倉庫 (Warehouse)
- ㉔ 倉庫 (Warehouse)
- ㉕ 倉庫 (Warehouse)
- ㉖ 倉庫 (Warehouse)
- ㉗ 倉庫 (Warehouse)
- ㉘ 倉庫 (Warehouse)
- ㉙ 倉庫 (Warehouse)
- ㉚ 倉庫 (Warehouse)
- ㉛ 倉庫 (Warehouse)
- ㉜ 倉庫 (Warehouse)
- ㉝ 倉庫 (Warehouse)
- ㉞ 倉庫 (Warehouse)
- ㉟ 倉庫 (Warehouse)
- ㊱ 倉庫 (Warehouse)
- ㊲ 倉庫 (Warehouse)
- ㊳ 倉庫 (Warehouse)
- ㊴ 倉庫 (Warehouse)
- ㊵ 倉庫 (Warehouse)
- ㊶ 倉庫 (Warehouse)
- ㊷ 倉庫 (Warehouse)
- ㊸ 倉庫 (Warehouse)
- ㊹ 倉庫 (Warehouse)
- ㊺ 倉庫 (Warehouse)
- ㊻ 倉庫 (Warehouse)
- ㊼ 倉庫 (Warehouse)
- ㊽ 倉庫 (Warehouse)
- ㊾ 倉庫 (Warehouse)
- ㊿ 倉庫 (Warehouse)

校舎以外の工作物

- ① 校舎 (School Building)
- ② 校舎 (School Building)
- ③ 校舎 (School Building)
- ④ 校舎 (School Building)
- ⑤ 校舎 (School Building)
- ⑥ 校舎 (School Building)
- ⑦ 校舎 (School Building)
- ⑧ 校舎 (School Building)
- ⑨ 校舎 (School Building)
- ⑩ 校舎 (School Building)
- ⑪ 校舎 (School Building)
- ⑫ 校舎 (School Building)
- ⑬ 校舎 (School Building)
- ⑭ 校舎 (School Building)
- ⑮ 校舎 (School Building)
- ⑯ 校舎 (School Building)
- ⑰ 校舎 (School Building)
- ⑱ 校舎 (School Building)
- ⑲ 校舎 (School Building)
- ⑳ 校舎 (School Building)
- ㉑ 校舎 (School Building)
- ㉒ 校舎 (School Building)
- ㉓ 校舎 (School Building)
- ㉔ 校舎 (School Building)
- ㉕ 校舎 (School Building)
- ㉖ 校舎 (School Building)
- ㉗ 校舎 (School Building)
- ㉘ 校舎 (School Building)
- ㉙ 校舎 (School Building)
- ㉚ 校舎 (School Building)
- ㉛ 校舎 (School Building)
- ㉜ 校舎 (School Building)
- ㉝ 校舎 (School Building)
- ㉞ 校舎 (School Building)
- ㉟ 校舎 (School Building)
- ㊱ 校舎 (School Building)
- ㊲ 校舎 (School Building)
- ㊳ 校舎 (School Building)
- ㊴ 校舎 (School Building)
- ㊵ 校舎 (School Building)
- ㊶ 校舎 (School Building)
- ㊷ 校舎 (School Building)
- ㊸ 校舎 (School Building)
- ㊹ 校舎 (School Building)
- ㊺ 校舎 (School Building)
- ㊻ 校舎 (School Building)
- ㊼ 校舎 (School Building)
- ㊽ 校舎 (School Building)
- ㊾ 校舎 (School Building)
- ㊿ 校舎 (School Building)

